

## WARNING

1. Switch off before installation / maintenance.
2. Switch on only after complete installation and examination of the circuit.
3. Professional electrician for installation and maintenance only.

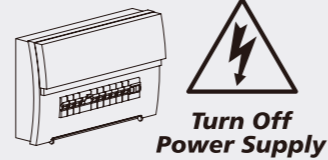

## How to Install

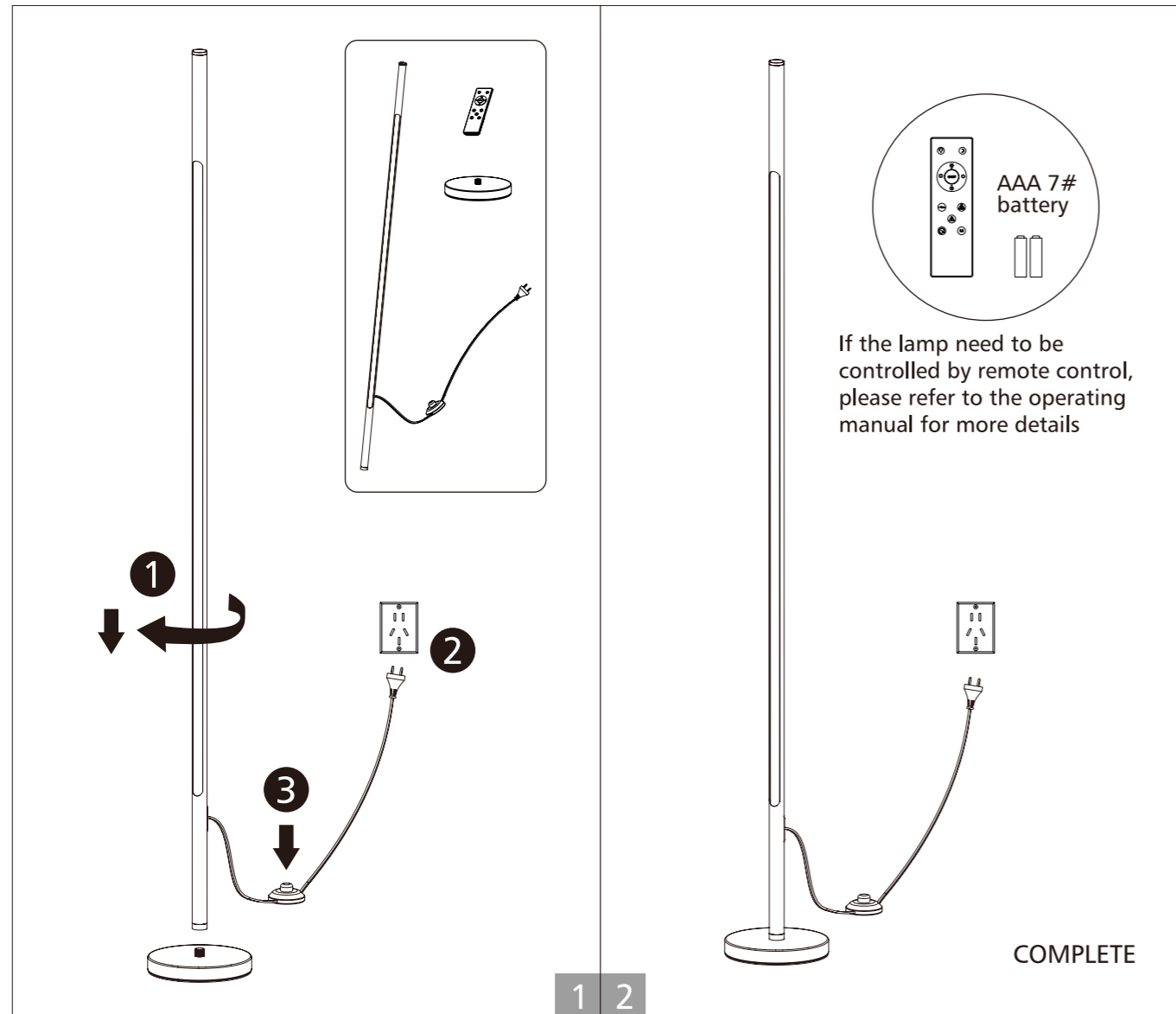

## 2.4G 12 KEY REMOTE CONTROLLER

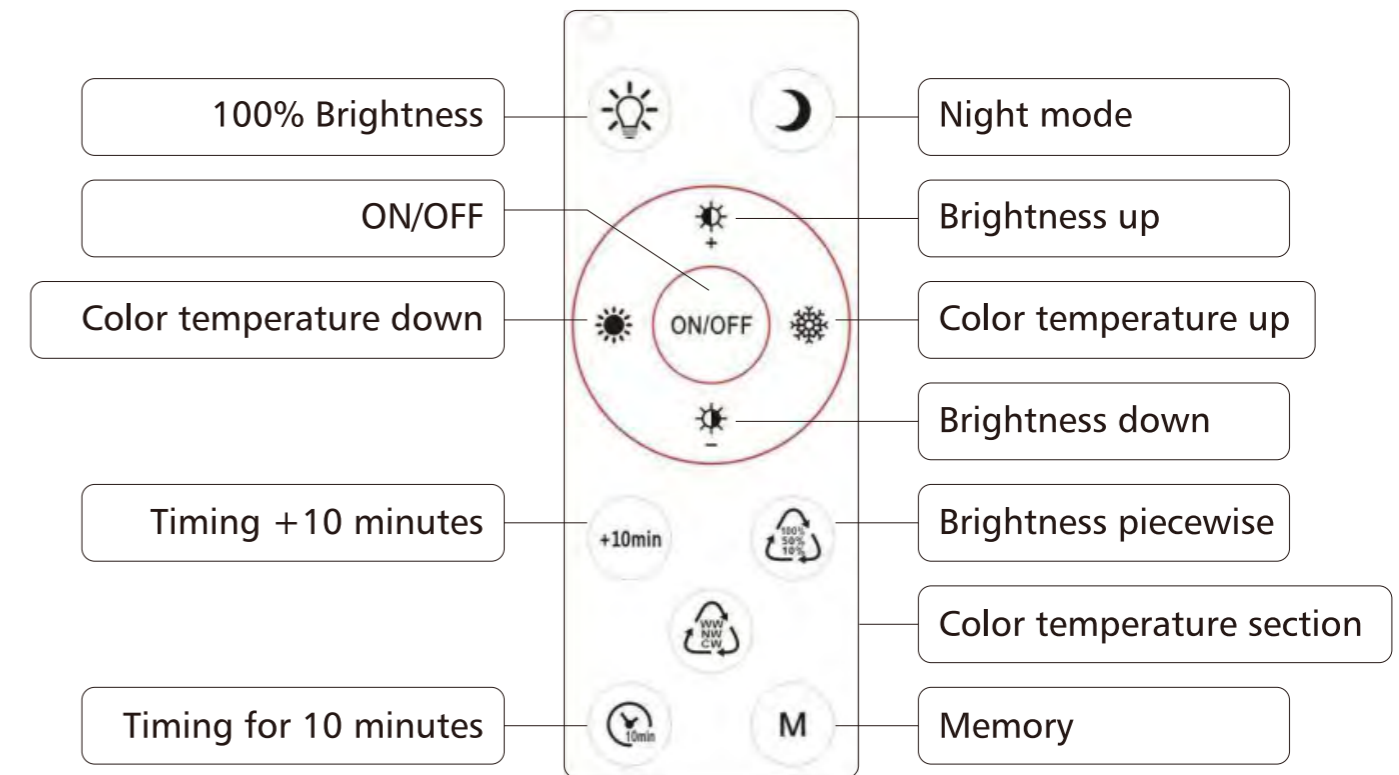



### (1). Night mode

Press  , lamp will change to 5% lux of warm CCT.

### (2). Function control

Press  , lamp will change to 100% lux.

Press  , lux increase.

Press  , lux decrease.

Press  , lamp will turn on/off.

Press  , change to colder CCT.

Press  , change to warmer CCT.



Press  , turn off after 10min.

Long press  for 3seconds, add 10min more for timing, 60min at most.

Press  , lux change with cycle 10%, 50%, 100%.

Press  , CCT change with cycle WW, NW, CW.

### (3). Memory function

Long press  for 3 seconds with a lamp flash, it will remember the current status. When CCT status changed, do a short press  , lamp will back to original remembered status. Turn off the lamp, then turn it on, lamp will keep remembered status.